



RESIDENCE

16 Mannering, East Kilbride, G74 3PA

www.residencestateagents.co.uk



Viewing by appointment with Residence Hamilton
T: 01698 444333 | E: hamilton@residenceestateagents.co.uk | A: 34 Cadzow Street, Hamilton, ML3 6DG





3 Bedrooms | 1 Public Rooms | 1 Bathrooms

This extensively modernised and upgraded 3-bedroom mid-terrace villa is in pristine walk-in condition and is sure to appeal to both families and first-time buyers. The property has been completely renovated with quality finishes throughout, featuring brand-new elements including a roof, kitchen, bathroom, carpets, and doors and heating system — offering a move-in ready home with nothing to do but enjoy.

The home has undergone a full refurbishment, finished to an exceptional standard.

The accommodation comprises a welcoming entrance porch, a spacious reception hallway with a staircase to the upper level, and a generous lounge overlooking the front. The contemporary fitted dining kitchen boasts new base and wall-mounted storage units, worktop surfaces, an integrated oven and hob, and an attractive splashback — perfect for modern living and entertaining. Upstairs, you'll find three bedrooms and a stylish, newly fitted family bathroom.

Additional features include gas-fired central heating, double glazing, low-maintenance gardens, and a garage.

Situated in Calderwood, the property is ideally located for all local amenities, including primary and secondary schools, sports and recreational facilities, and regular bus services. It offers convenient access to the Town Centre, Village, East Kilbride Train Station, and Kingsgate Retail Park. Commuters will appreciate the easy connection to the M74 and M77 motorways, making this an excellent location for travel.



796.00 sq ft | EER = C



RESIDENCE





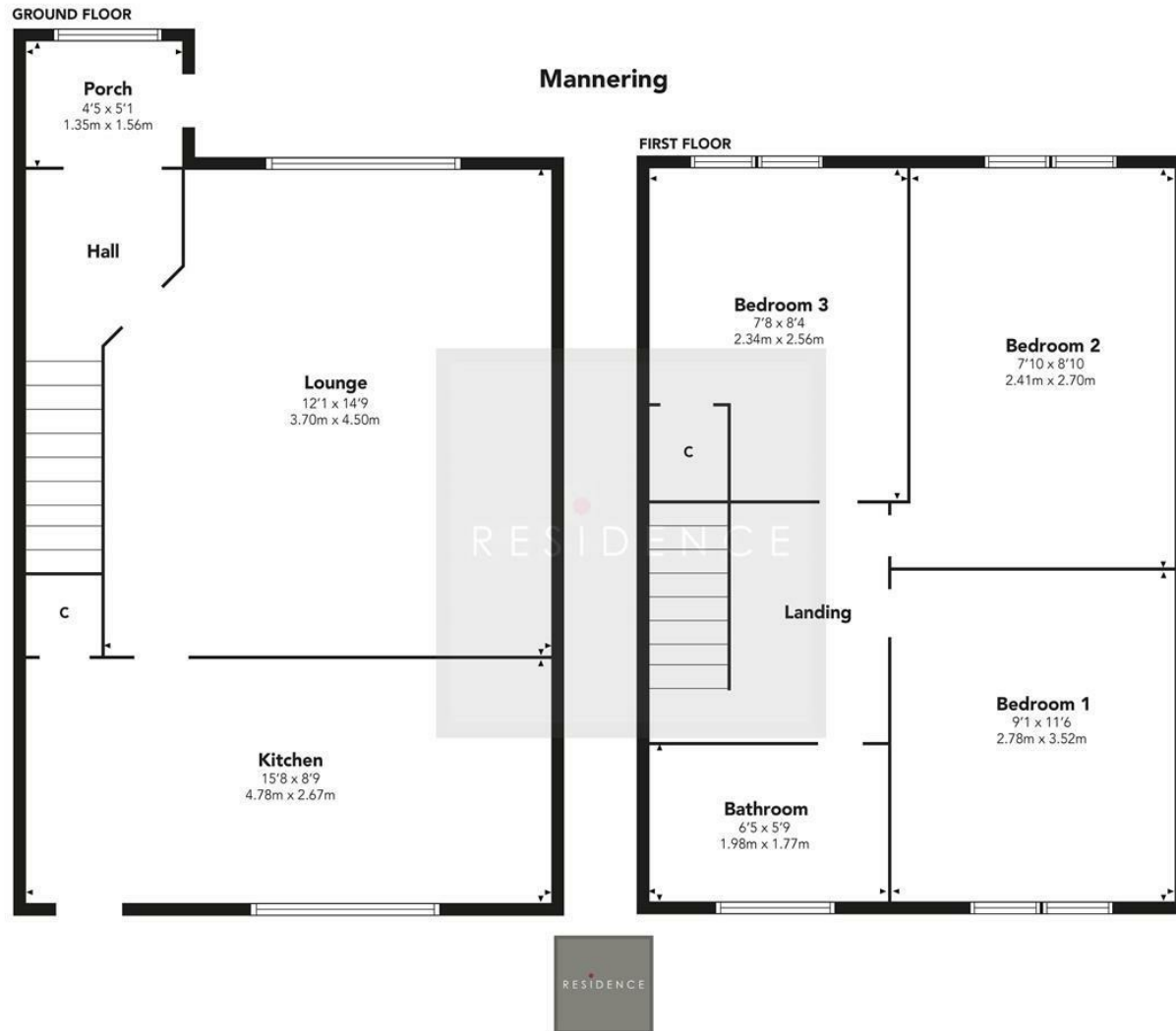

Floor Plan measurements are approximate and are for illustrative purposes only.
While we do not doubt the floor plans accuracy, we make no guarantee, warranty or representation
as to the accuracy and completeness of the floor plan. You or your advisors should conduct a careful,
independent investigation of the property to determine to your satisfaction as to the suitability
of the property for your space requirements.

Produced by Plush Plans Ltd

We believe these details to be accurate; however, they do not form any part of a contract. Fixtures and fittings are not included unless specified in the enclosed. Photographs are for general information and it must not be inferred that any item is included for sale with the property. All distances and measurements are approximate. Floorplans may not be to scale and are for illustration purposes only.